

FloPlast
building the future

MDPE Systems Brochure

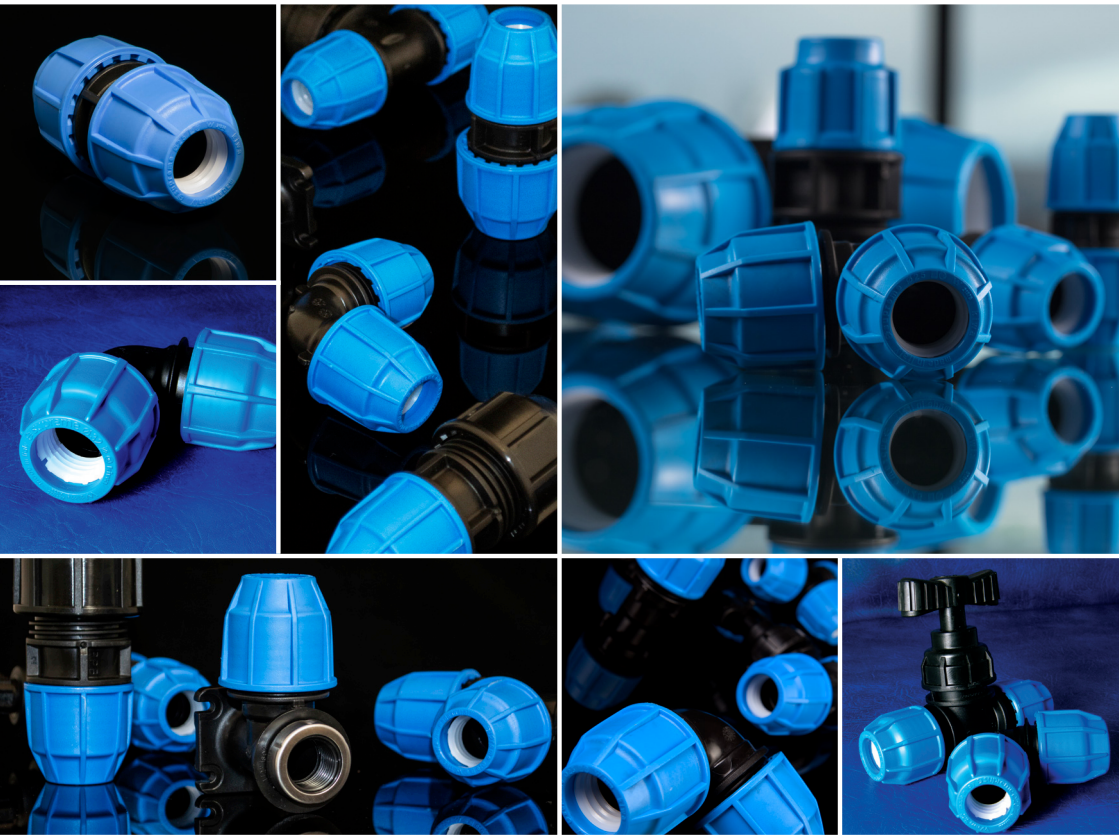

www.floplast.co.uk

MDPE SYSTEMS

Introduction to MDPE Systems

FloPlast 'Supreme' range offers everything you could ask for in a compression fitting. They are suitable for use below ground on cold water services with polyethylene pipes manufactured in accordance with the requirements of BS EN 12201 - 2 : 2011 (BLUE).

Features and Benefits:

- High Impact resistant Body and Nut which enables it to absorb thermal and mechanical stress.
- The fittings have a co-polymer polypropylene Body, Body Nut and Guide Ring, Acetal Grab Ring and Nitrile Seal.
- Excellent pressure resistance, tested to 48 Bar. Comfortably exceeds the performance requirements of UK Water Byelaws Scheme.
- Tested and approved by various testing institutes worldwide.
- Water Regulations Advisory Scheme Approved (WRAS) product. 20mm to 110mm range of fittings.
- Simple and quick to connect:
 - to fit the pipe you don't need to dismantle the connector.
 - you don't need to chamfer the pipe.
 - you won't lose any pieces on the job site.
 - no time wasted; just cut the pipe, insert pipe liner, lubricate the seal, undo the nut a few turns, push the pipe in as far as it will go, tighten the nut and it's done!

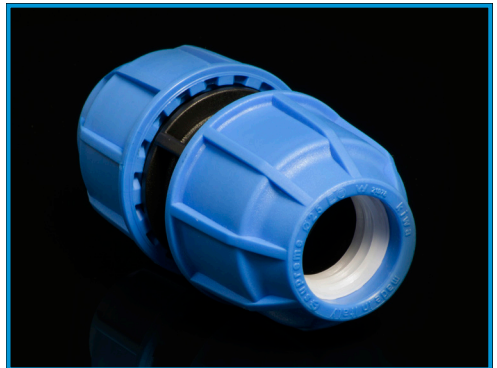

Medium Density Polyethylene Pipe (MDPE) 12 Bar Material: Polyethylene

	25m Coil	50m Coil	100m Coil	150m Coil
Nom Size O.D	Code	Code	Code	Code
20mm Pipe	111601	111602	111603	111604
25mm Pipe	112601	112602	112603	112604
32mm Pipe	113601	113602	113603	113604
50mm Pipe	115601	115602	115603	115604
63mm Pipe	116601	116602	116603	116604

MDPE SYSTEMS

“Supreme” MDPE Fittings (16 Bar)

Material: Polyethelene Standard: BS EN 12201-2

Product	Size	Code
	20mm	491042
	25mm	492042
	32mm	493042

Product	Size	Code
	20mm	491000
	25mm	492000
	32mm	493000

Adaptors Kit for copper pipe BS EN 1057 (Pull out resistant)		
	20 x 15mm Copper	491003
	25 x 22mm Copper	492003

Universal Adaptors - Fits plastic, lead, copper and zincplated pipes		
	20 x 15-21mm	491007
	25 x 15-21mm	492007
	25 x 21-27mm	492008
	25 x 27-34mm	492009

Terminal Cap		
	20mm	491006
	25mm	492006
	32mm	493006

Coupling		
	20mm	491012
	25mm	492012
	32mm	493012
	50mm	495012
	63mm	496012

Reducing Coupling		
	25 x 20mm	492113
	32 x 25mm	493213
	50 x 32mm	495313

Wall Plate Elbow		
	20mm x 1/2"	491105
	25mm x 3/4"	492205

Product	Size	Price
	20mm	491015
	25mm	492015
	32mm	493015
	50mm	495015
	63mm	496015

90° Tee		
	20mm	491024
	25mm	492024
	32mm	493024
	50mm	495024
	63mm	496024

Male Adaptor		
	20mm x 1/2"	491102
	20mm x 3/4"	491202
	25mm x 1/2"	492102
	25mm x 3/4"	492202
	25mm x 1"	492302
	32mm x 3/4"	493202
	32mm x 1"	493302

Female Adaptor		
	20mm x 1/2"	491103
	20mm x 3/4"	491203
	25mm x 1/2"	492103
	25mm x 3/4"	492203
	25mm x 1"	492303
	32mm x 3/4"	493203
	32mm x 1"	493303

Reducing 90° Tee		
	25 x 20 x 25mm	492125
	32 x 25 x 32mm	493225
	50 x 32 x 50mm	495325

Fitting Instructions

1. Pipe and fitting preparation

Cut the pipe square and remove any burrs (insert pipe liner).

Unscrew the nut to the last thread leaving it on the fitting.

2. Pipe Insertion

Twist the pipe into the fitting up to the first stop. The pipe has reached the pipe guide and seal.

The pipe guide aids pipe insertion ensuring that the seal is correctly located.

3. Insert up to the body pipe stop

Push the pipe through the pipe guide and seal until it reaches the stop within the body.

Pipe Size	Insertion Depth
20mm	55mm
25mm	55mm
32mm	70mm

For MDPE materials the pipe should not normally be cold bent to a radius less than 25 times the outer diameter of the pipe. In special circumstances and only in the smaller service diameters this requirement may be relaxed to 15 x O.D for SDR 11 pipe, provided no joints or tapings occur on the bend and great care is taken not to kink the pipe.

4. Screwing the nut

Tighten the nut by hand.

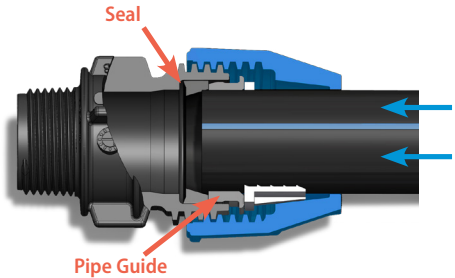
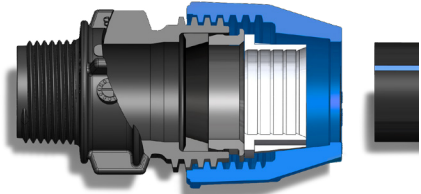

Body pipe with internal ribs

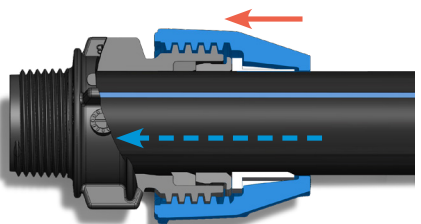
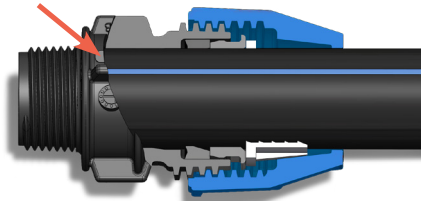

Universal Adaptor

Features

- PP-B body and EPDM gasket.
- Working pressure PN 10 at 20°C.
- Stainless steel grippers, incorporated in the clap ring, provide pull out resistance.
- Universal adaptors are available in 20mm and 25mm MDPE.
- No special tools required.
- Suitable for lead, copper, zinc plated and plastic pipes.



PE Outlet



Universal Outlet

- PVC
- Imperial PE
- LD-MD-HD PE
- Galvanised
- Lead
- Copper



Contact Details:

FloPlast Limited
 Castle Road
 Eurolink Business Park
 Sittingbourne
 Kent ME10 3FP
 UK

Tel
 01795 431731

Sales Office Direct Line
 01795 421422

Fax
 01795 431188

E-mail
sales@floplast.co.uk

Website
www.floplast.co.uk



Brochures available:



Roofline, Window and
 Cladding Systems



Rainwater
 Systems



Soil & Waste
 Systems



Underground Drainage
 Systems



MDPE
 Systems



Hot & Cold
 Plumbing Systems